

PRODUCT DATA SHEET

SKP DIN 46235 TYPE CABLE LUG

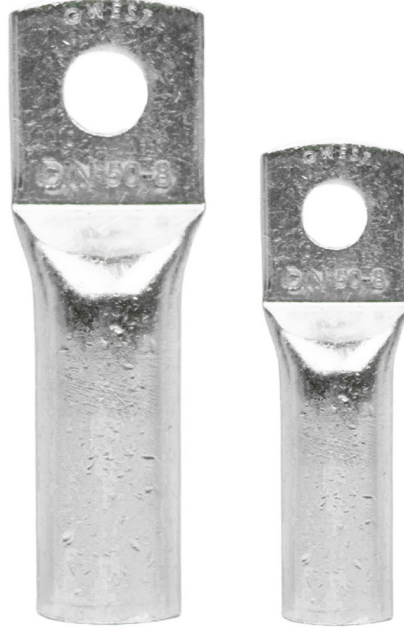

DESCRIPTION

A cable lug is attached to an electrical device such as a wire or cable and then securely fastened to its end using a crimp tool and crimp die.

FEATURES

- Made of copper material in accordance with EN/13600 standards.
- Annealed copper pipes are used during production.
- Copper with 99.9% conductivity is used in production.
- 100% Tin coating is made in the range of 5-8 Microns.

MARKINGS



- It complies with CE standards.
- It complies with RoHS standards.
- It complies with ISO 9001 standards.
- It complies with IEC standards.
- It complies with TSE standards.
- Domestic Production.

PRODUCT DATA SHEET

SKP DIN 46235 TYPE CABLE LUG

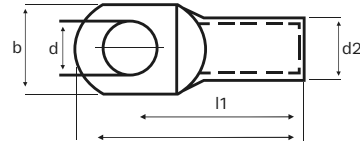
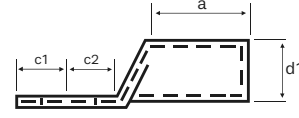

SECTIONS AND DIMENSIONS

PRODUCT CODE	CABLE SECTION (mm ²)	BORE DIAMETER Ø	DIMENSIONS							
			d	d1	d2	l1	a	b	c1	c2
SKP-D 10-5	10 mm ²	M5	5,3	4,5	7,0	27,0	10,0	9,0	7,0	8,5
SKP-D 10-6		M6	6,4	4,5	7,0	27,0	10,0	9,0	7,5	8,5
SKP-D 16-6	16 mm ²	M6	6,4	5,5	8,5	36,0	20,0	13,0	7,5	8,0
SKP-D 16-8		M8	8,4	5,5	8,5	36,0	20,0	13,0	10,0	10,0
SKP-D 16-10		M10	10,5	5,5	8,5	36,0	20,0	17,0	12,0	12,0
SKP-D 25-6	25 mm ²	M6	6,4	7,0	10,0	38,0	20,0	14,0	7,5	8,0
SKP-D 25-8		M8	8,4	7,0	10,0	38,0	20,0	16,0	10,0	10,0
SKP-D 25-10		M10	10,5	7,0	10,0	38,0	20,0	17,0	12,0	12,0
SKP-D 25-12		M12	13,0	7,0	10,0	38,0	20,0	19,0	13,0	13,0
SKP-D 35-8	35 mm ²	M8	8,4	8,2	12,5	42,0	20,0	17,0	10,0	10,0
SKP-D 35-10		M10	10,5	8,2	12,5	42,0	20,0	19,0	12,0	12,0
SKP-D 35-12		M12	13,0	8,2	12,5	42,0	20,0	21,0	13,0	13,0
SKP-D 50-8	50 mm ²	M8	8,4	10,0	14,5	52,0	28,0	20,0	10,0	10,0
SKP-D 50-10		M10	10,5	10,0	14,5	52,0	28,0	22,0	12,0	12,0
SKP-D 50-12		M12	13,0	10,0	14,5	52,0	28,0	24,0	13,0	13,0
SKP-D 50-16		M16	17,0	10,0	14,5	52,0	28,0	28,0	16,0	16,0
SKP-D 70-8	70 mm ²	M8	8,4	11,5	16,5	55,0	28,0	24,0	10,0	10,0
SKP-D 70-10		M10	10,5	11,5	16,5	55,0	28,0	24,0	12,0	12,0
SKP-D 70-12		M12	13,0	11,5	16,5	55,0	28,0	24,0	13,0	13,0
SKP-D 70-16		M16	17,0	11,5	16,5	55,0	28,0	30,0	16,0	16,0